

Venue Overview

Elegant & Cosmopolitan Atmosphere in the Gaslamp Quarter
Innovative & Modern Italian Cuisine • Local & Fresh Ingredients



Bice Lounge Bar

20 To 50 Guests

Upbeat and sleek space fits 50 guests for a cocktail reception.
The lounge offers a semiprivate casual reception event.
Combined with Milano Room fits 100 guests (reception)
Combined with Main Dining Room fits 150 guests (reception)



Main Dining Room

60 To 150 Guests

Can seat up to 150 max and host stand up event up to 160
Stunning View of the Wine Cellar
BiCE Cheese Bar
Award-Winning Cheese Bar with more than 30 Italian Cheeses



The Grand Torino Room

52 To 80 Seats

Private Entrance with small Patio
Private Restrooms
Two 65" Ultra HD LCD TVs for flawless quality presentation
Combines with Milano room for sit-down dinners up to 130



Milano Room

15 To 52 Seats

Sophisticated PRIVATE ROOM featuring a versatile square layout. Includes built-in projector with 83" screen, independent audio streaming, WiFi, and floor-to-ceiling windows overlooking the Gaslamp Quarter.
Boardroom Set-Up: 15 guests
Sit Down Dinner Set-Up: 52 guests

See Backside for Full Floor Layout

For private events, inquiries, & venue buyouts please contact:
admin@bicesandiego.com or 619-239-2423

Bice San Diego **Venue Layout**

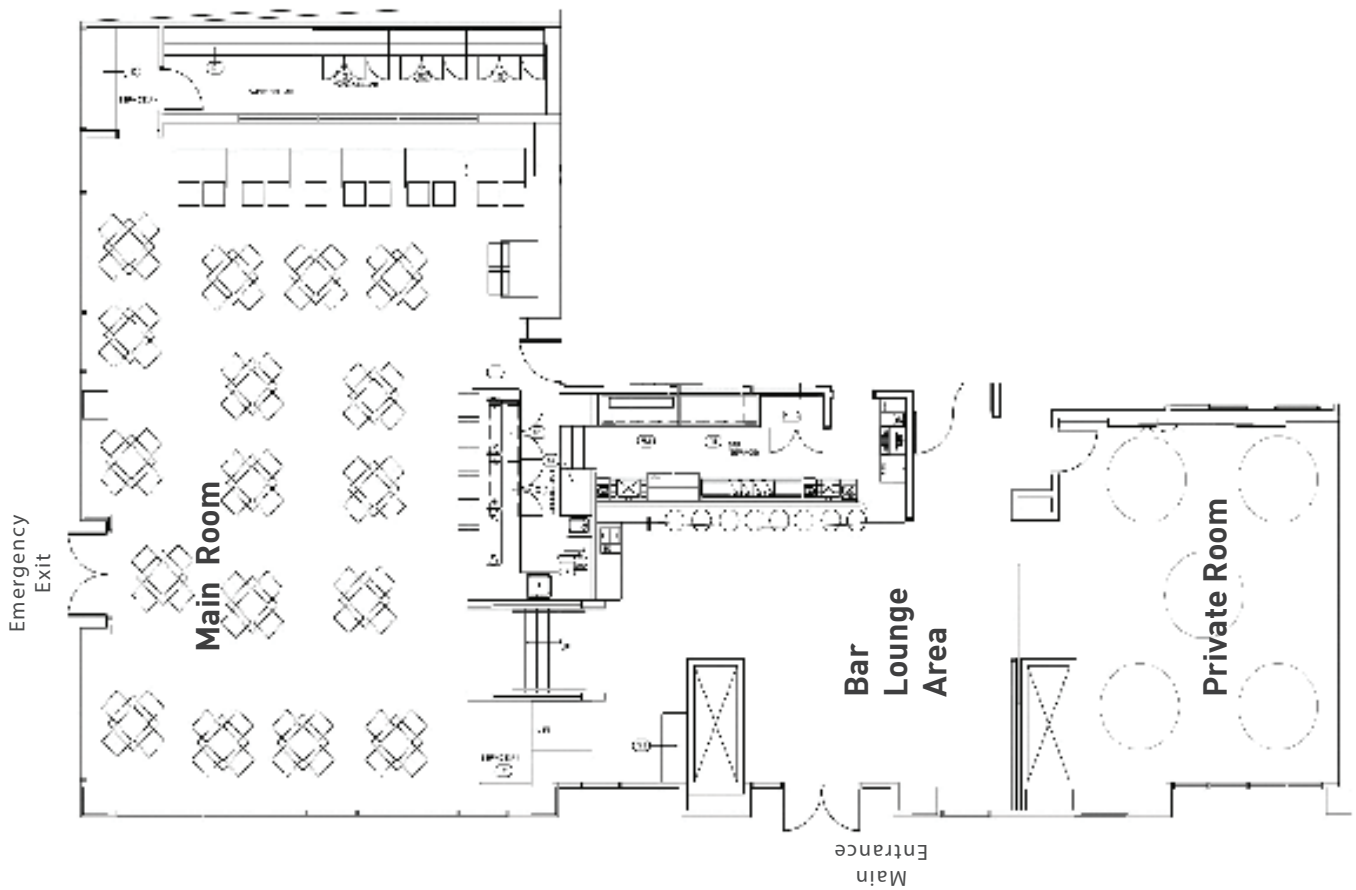

Milano Room Diagram Party of 52

Maximum Capacity:
Seat Down Dinner: 52
Cocktail Style: 65

Sliding Door Separates Torino Room

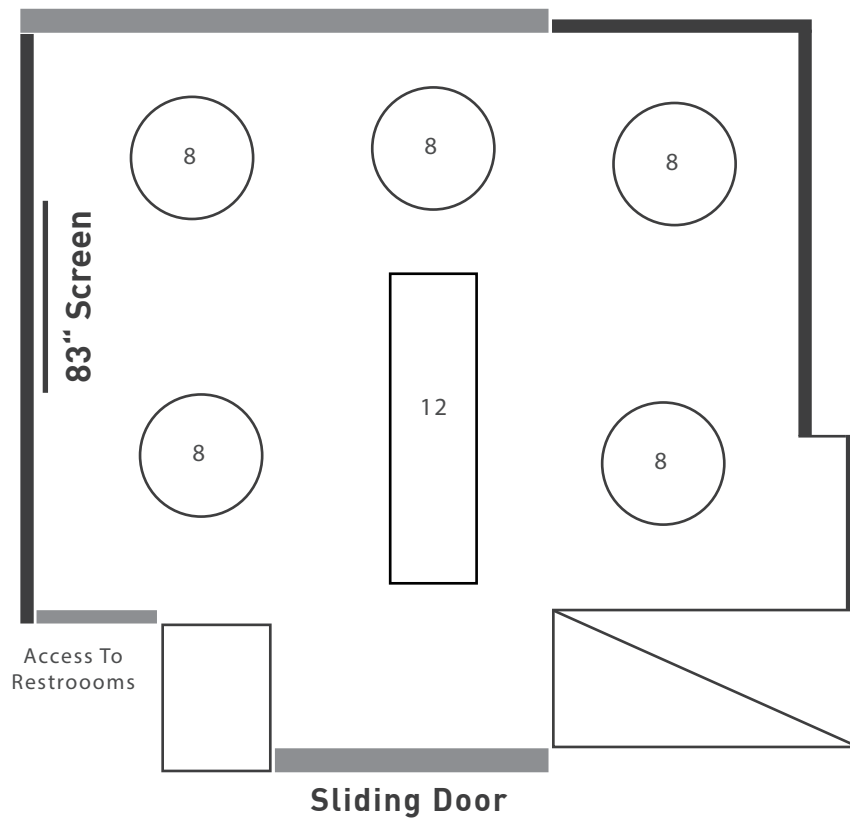

Torino Room **Diagram Party of 80**

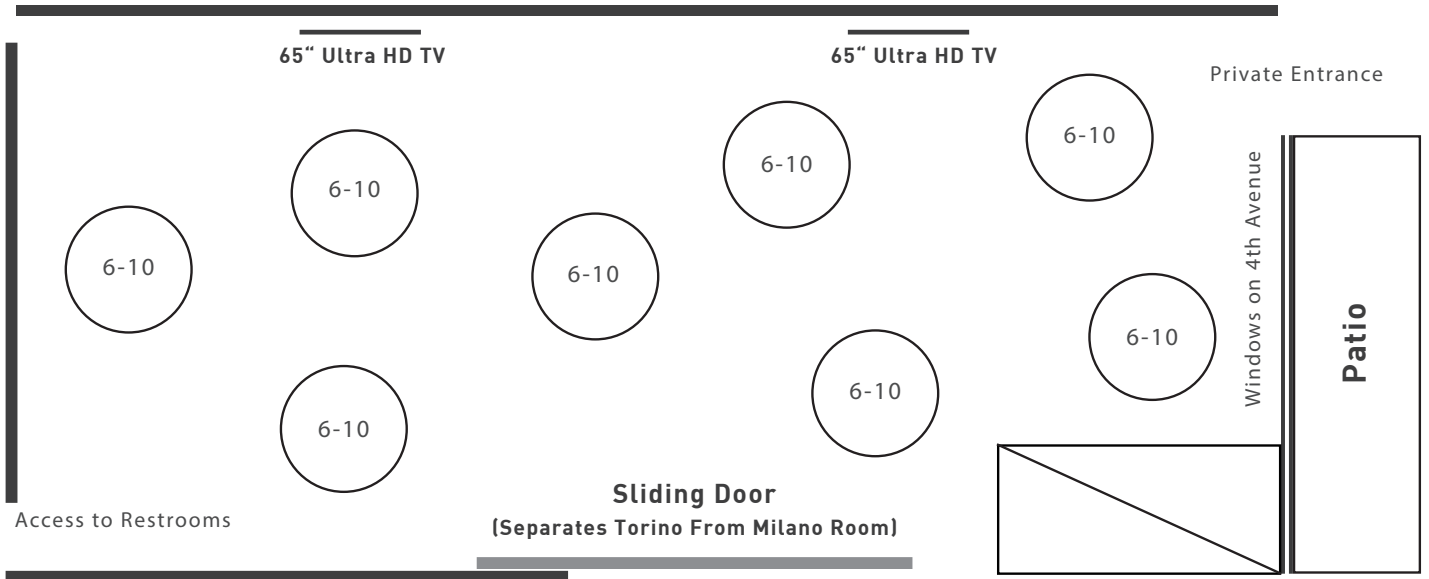

Milano + Torino Room Diagram Party of 132

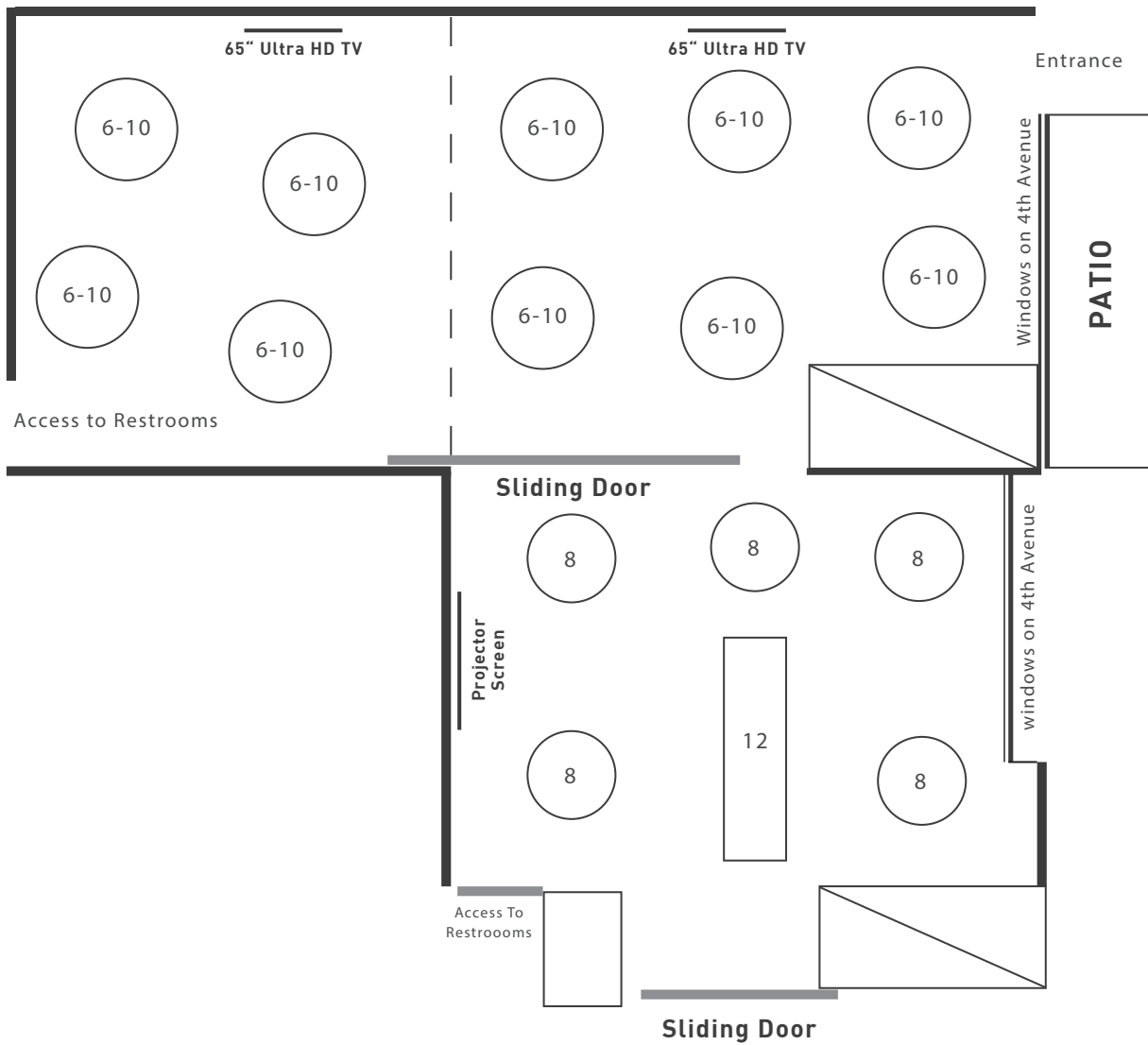

Main Dining Room Floor Map

Maximum Capacity: Diagram
Seat Down: 150
Cocktail Style: 180

